

SIGNED DRAWINGS MUST ACCOMPANY PURCHASE ORDER OR DIMENSIONS OF FITTINGS WILL NOT BE GUARANTEED

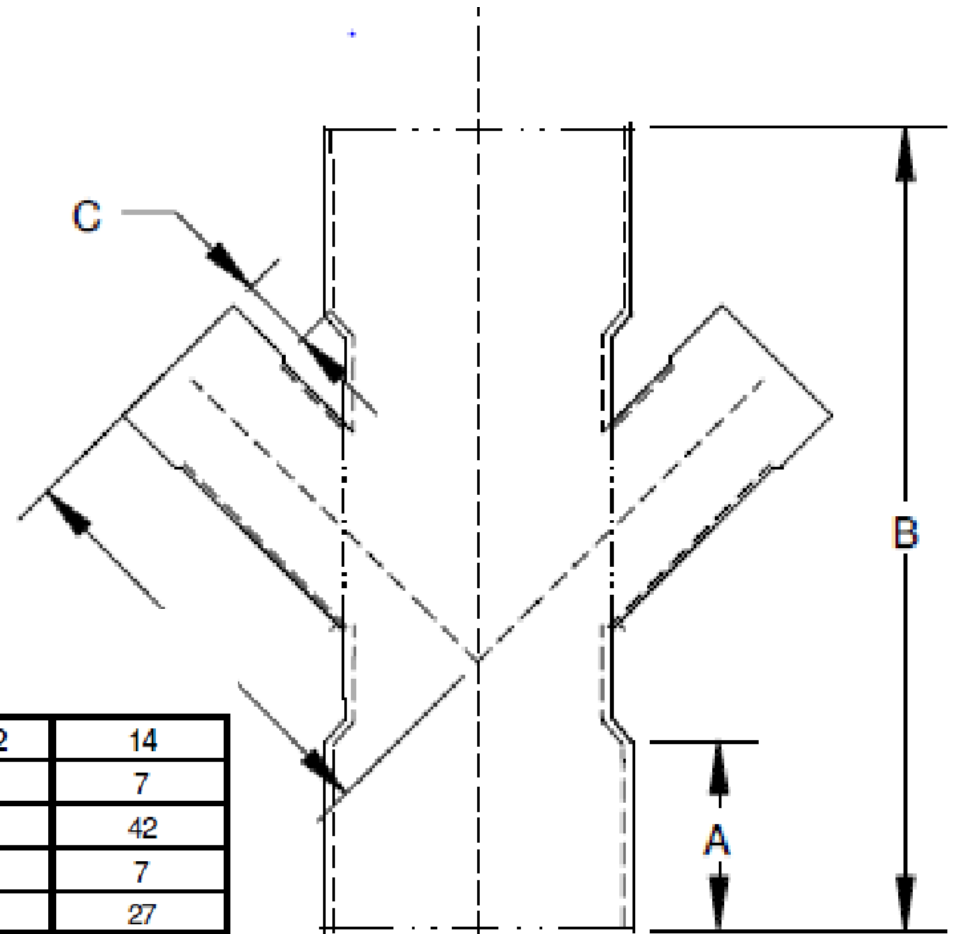

SIZE	14X4	14X6	14X8	14X10	14X12	14
A	7	7	7	7	7	7
B	27	30	33.5	36.5	39.5	42
C	2.25	3.5	4.5	5.5	6.5	7
D	15.5	18.5	21	24	25.5	27

**DISCLAIMER - PLEASE READ**

- DUE TO VARIOUS FACTORS AFFECTING PRODUCTION, ALL DIMENSIONS ARE APPROXIMATE
- DIMENSIONS AND APPEARANCE ARE SUBJECT TO CHANGE WITHOUT NOTICE DUE TO DESIGN OR PRODUCTION MONIFICATIONS
- ANGLE TOLERANCE FOR ELBOWS IS +/- 2 DEGREES.
- ALL OTHER DIMENSIONS ARE TO TOLERANCES OF +/- 1"
- ALL FITTINGS ARE SUBJECT TO P.T.I. "STANDARD TERMS AND CONDITIONS"

**14" DOUBLE 45 DEGREE WYE  
SOLVENT WELD DWV  
14"x14"x14"x14" HxHxHxH**

**ROYAL** Building Products

56400 Mound Road, Shelby Township, MI 48316  
Phone (586)781-2700 Fax (586)781-0888

PRINTED COPIES ARE FOR REFERENCE ONLY

DATE: 5/6/2014 DRAWN BY: BCS

DATE: 5/6/2014 CHECKED BY: RBP

D3614.S

CUSTOMER