

MOLDED

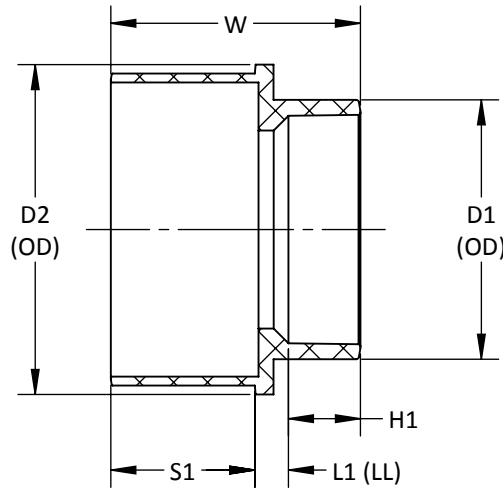

ASTM D3034, CSA B182.2
ASTM D2665, F1866, CSA B181.2
WHERE APPLICABLE

**DWV ADAPTER BUSHING SxH (SDR 35)
SOLVENT WELD (SHORT) SEWER SPIGOT x SOLVENT WELD DWV HUB**

PART NO.	SIZE IN INCHES	L1	S1	H1	W	D1	D2
* P1202	3 x 1-1/2	3/8	1 17/32	23/32	2 5/8	2 1/4	3 15/32
* P1203	3 x 2	9/32	1 17/32	25/32	2 19/32	2 23/32	3 15/32
* P1204	4 x 1-1/2	13/32	1 25/32	23/32	2 29/32	2 1/4	4 1/2
* P1205	4 x 2	5/16	1 25/32	25/32	2 7/8	2 23/32	4 1/2
* P1211	4 x 3	3/32	1 25/32	1 17/32	3 13/32	3 31/32	4 1/2
* P1213	4 x 4	5/32	1 25/32	1 25/32	3 23/32	5 1/32	4 1/2
* P1214	6 x 4	1 5/32	3 1/16	1 25/32	6	5 1/32	6 11/16
* P1215	6 x 6	7/32	3 1/16	3 1/16	6 11/32	7 7/32	6 11/16

-- DIMENSIONS AND APPEARANCE ARE APPROXIMATE AND SUBJECT TO CHANGE
WITHOUT NOTICE DUE TO DESIGN OR PRODUCTION MODIFICATIONS
-- MOLDED FITTING TOLERANCE = ±1/8" OVERALL LENGTH
-- FABRICATED FITTING TOLERANCE = ±1" LINEAR, ± 2° ANGULAR

* MOLDED FITTING
† ASSEMBLED FROM MOLDED COMPONENTS
ALL OTHER FITTINGS ARE FABRICATED