

SIGNED DRAWINGS MUST ACCOMPANY PURCHASE ORDER OR DIMENSIONS OF FITTINGS WILL NOT BE GUARANTEED

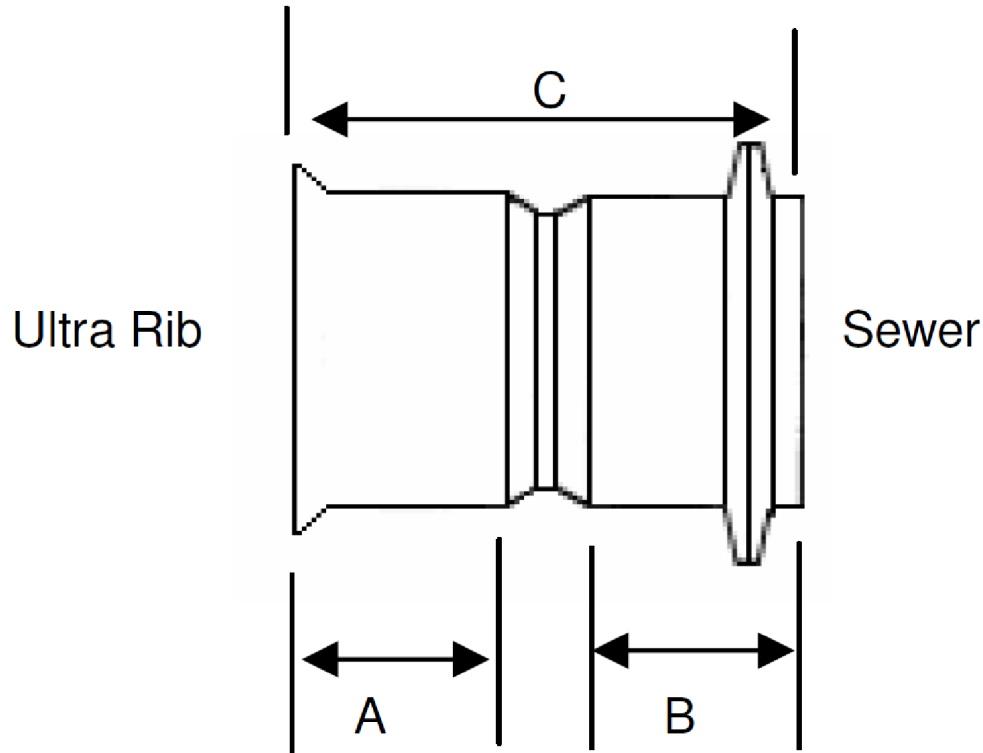

SIZE	12*
A	6.5
B	6.5
C	16

Note:
 Fitting shall be constructed from solid-walled PVC pipe conforming to ASTM D3034. Gasket joint shall conform to ASTM D3139 with gasket conforming to ASTM F477. Ultra-Rib bell is suitable for connection to ASTM F794 Ultra-Rib brand corrugated pipe with a gasket. This joint shall conform to ASTM D3139.

DISCLAIMER - PLEASE READ

- DIMENSIONS AND APPEARANCE ARE APPROXIMATE AND SUBJECT TO CHANGE WITHOUT NOTICE DUE TO DESIGN OR PRODUCTION MODIFICATIONS
- ANGLE TOLERANCE FOR ELBOWS IS +/- 2 DEGREES.
- ALL OTHER DIMENSIONS ARE TO TOLERANCES OF +/- 1"
- ALL FITTINGS ARE SUBJECT TO RBP "STANDARD TERMS AND CONDITIONS"

ROYAL[™] Building Products

royalbuildingproducts.com

56400 Mound Road, Shelby Township, MI 48316
 Phone (800)232-5690 -- Fax (586)781-0888

PRINTED COPIES ARE FOR REFERENCE ONLY

DATE: 2/13/2015 DRAWN BY: RKS

DATE: 2/13/2015 CHECKED BY: RBP

K6412.S

CUSTOMER

**12" PROFILE ADAPTER COUPLING
 PVC SDR35 GASKETED SEWER x ULTRA RIB BELL
 12" x 12" BxG**